

# SIRCO *M* and *MV*

Modular universal switches  
from 16 to 160 A



## SOCOMEK : Innovators in LV switching solutions

As a world leader in electrical switching and protection systems, SOCOMEC launches a new generation of load break and changeover switches for applications from 16 to 160 A.

### **SIRCO M** and **MV** : Total integration of all electrical functions: isolating, control and changeover switching

SOCOMEK has developed a new technical concept that combines the features of a load break switch and a changeover switch in order to propose a highly innovative modular design.

### **SIRCO M** and **MV** : Full compliance with IEC, EN 60947-3 or UL 508 standards

The new **SIRCO M** and **MV** range of load break switches has been designed, qualified and tested according to the criteria defined by the IEC 60947-3 standard.

This process guarantees a high quality level for the product which is fully adapted to arduous operating environments when operating in the field.



ATYS 079 A

## ADDITIONAL SOCOMEK SWITCHING SOLUTIONS

### > **SIRCO** load break switches up to 5000 A

SIRCO 353 A

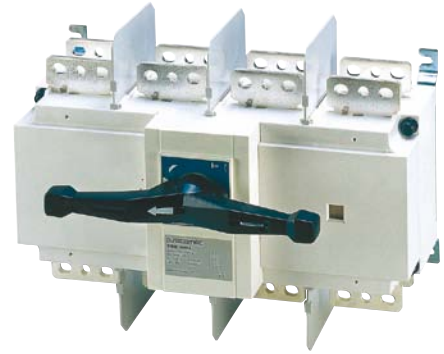

### > Manual and motorised changeover switch

ATYSM 007 A



### > Fuse combination switches **FUSERBLOC** - Front or right side operation

FUSER 703 A

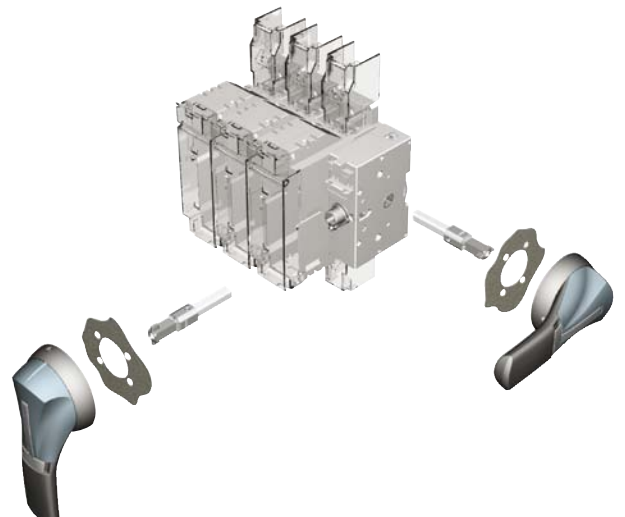

# SIRCO M Modular universal switches the versatile solution

Use standard components to create a solution that perfectly suits to your application.

## SWITCHING & DISCONNECTION

For safe and optimised operation of LV electrical circuits.

## CHANGEOVER SWITCHING

Two mechanically interlocked switches.

## ADAPTABLE

To all motor or distribution load applications.

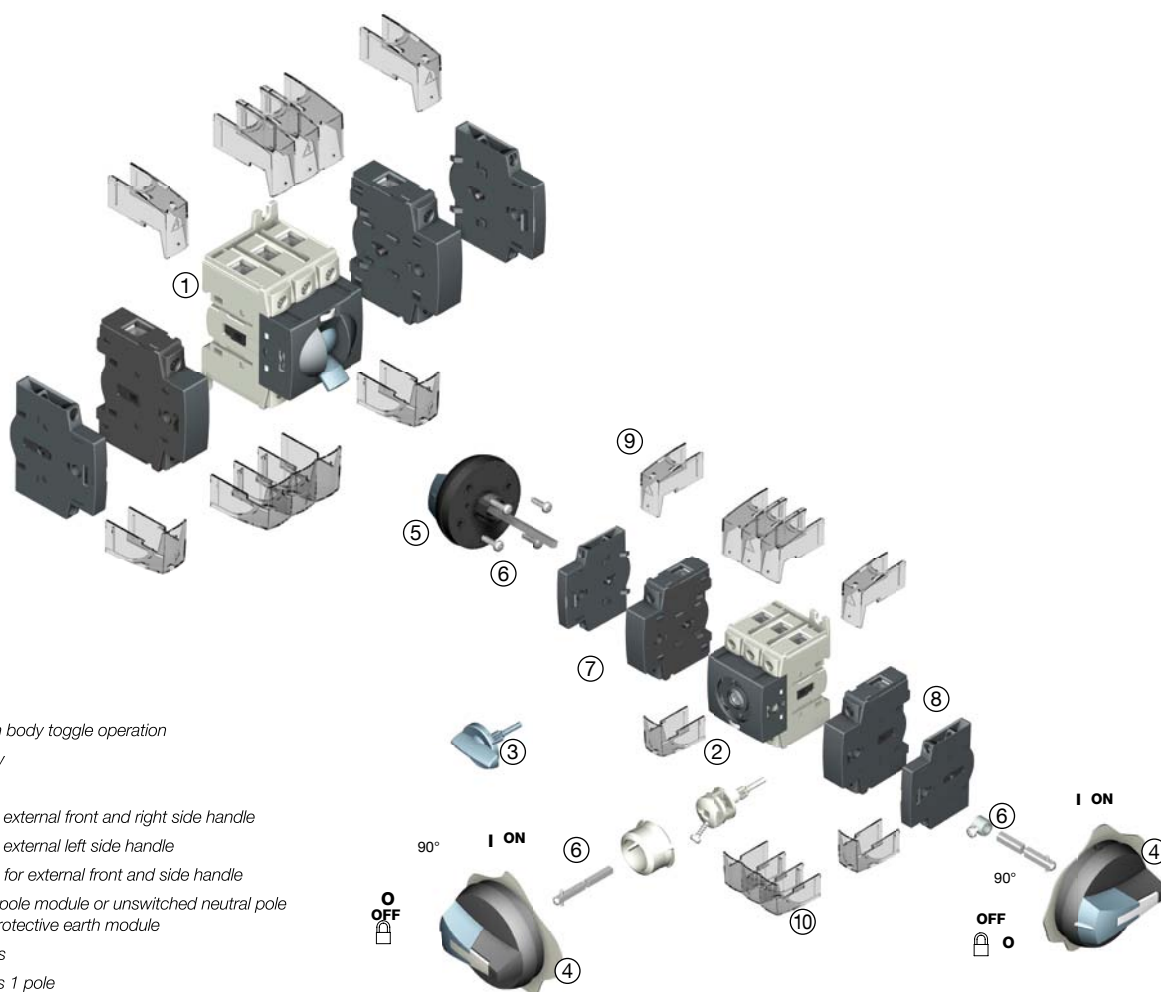

## COMPLETE INTEGRATION WITHIN ALL OF YOUR INSTALLATIONS

- > Distribution panel - Incoming or feeder
- > Panel mounted or DIN modular
- > Machine control
- > Local safety break

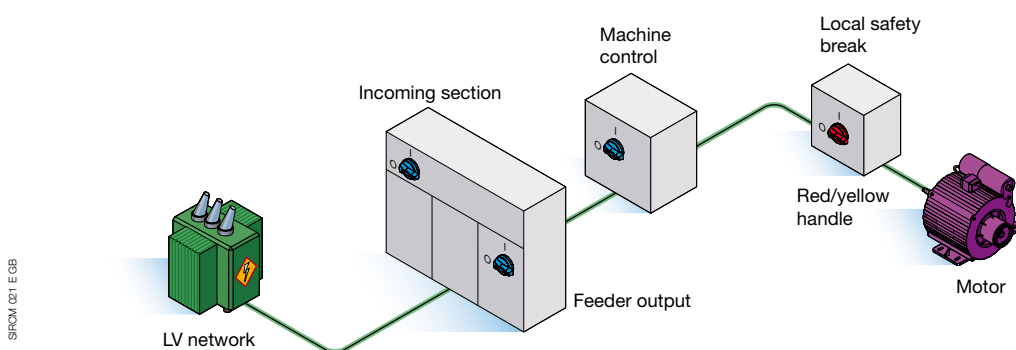



### AN OPTIMISED BREAKING SYSTEM

#### > SIRCO M

Contact point technology and front or side operation.



SIRCO 163 A - 164 A



Position 0



Position I

#### > SIRCO MV

Sliding electrical contacts:

- High dynamic short circuit current withstand,
- High number of operations.



### STANDARDISED ACCESSORIES

#### > Direct operation

A direct operation to suit all markets.

SIRCO 132 A - 133 A



Rotary handle



Lever operation (toggle)

#### > External operation

Compact and robust, the rotary handle enables the same switch to be operated either from a front, left or right side.

ACCESS 278 A - 279 A



16 to 80 A



100 to 160 A

#### > Additional poles

3 additional pole versions are available:

- a switched fourth pole module,
- an unswitched neutral pole,
- a protective earth module (unswitched pole).

SIRCO 072 B



#### > Auxiliary contacts

The pre-break and signalisation function of these auxiliary contacts enables the anticipation of the switching of the main poles.

SIRCO 075 B



#### > Terminal shrouds

Single, three and four pole they ensure protection against direct contact.

SIRCO 012 A



### NEW ADDITIONAL FEATURES

#### > Door / Panel mounting kit

For a quick and easy installation.



Overall dimensions reduced



Right or left side mounting



Door mounting



Complete protection IP2X

#### > Conversion kit

This accessory enables the assembly of two 3 pole switches + additional poles in order to achieve:

- 6 or 8 pole load break switches,
- 3 or 4 pole changeover switches (I - 0 - II) or (I - I+II - II).



# SIRCO M and MV

Ten **multipolar** ratings from 16 to 160 A  
for LV **industrial and commercial applications**

**SIRCO M** 16 to 40 A      **SIRCO M** 63 to 80 A      **SIRCO M** 100 and 125 A      **SIRCO MV** 100 to 160 A

## FUNCTIONS

3/4-pole load break switches	•	•	•	•
6/8-pole load break switches	•	•		
3/4-pole changeover switches (I - 0 - II)	•	•		
3/4-pole changeover switches (I - I+II - II)	•	•		

## CHARACTERISTICS

### OPERATION

Manual	•	•	•	•
Lever (Toggle)	•	•		

### DIRECT HANDLE

Front	•	•	•	•
-------	---	---	---	---

### DOOR INTERLOCKED EXTERNAL HANDLE

Front	•	•	•	•
Right side	•	•	•	•
Left side	•	•	•	•

### BREAKING

Positive break indication	•	•	•	•
Visible				•

### SWITCH BODY

Modular	•	•	•	•
---------	---	---	---	---

## Compact enclosure

- Polycarbonate housing.
- IP65.
- 2 colourings:
  - grey lid and black handle,
  - yellow lid and red handle.
- 2 enclosure sizes to facilitate the connection:
  - **16 to 40 A case**  
(H x L x P :162 x 66 x 92 mm) pre-drill holes:  
2 on the right and 2 on the left side M16, 2 on the top and 2 on the bottom M20/25, 4 on the backside M20,
  - **63 to 100 A**  
(H x L x P : 210 x 125,5 x 92mm) pre-drill holes:  
2 on the right and 2 on the left side M16, 2 on the top and 2 on the bottom M25/32, 2 on the backside M25/32.
- Removable neutral and earthing terminals.
- Lid fixed by sealed screws.
- Sectile mounting lugs.

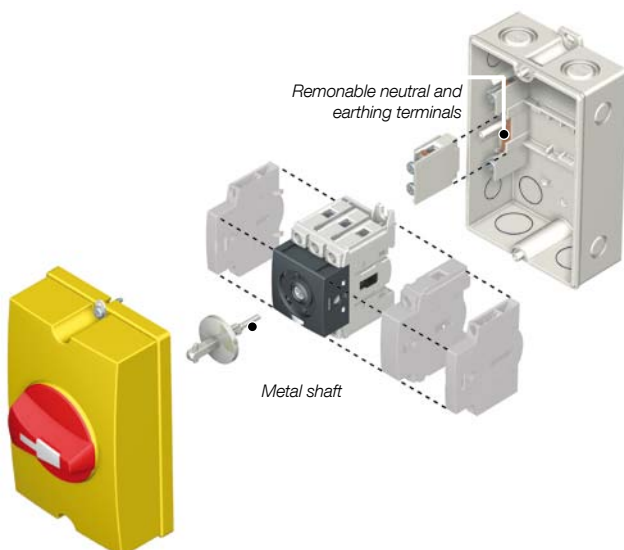

## SIRCO MV

The appropriate product for all **enclosed applications**

### > Mounting inside an enclosure

- DIN rail mounted



- Back plate mounted



### > Voltage tap

Voltage sensing and power supply accessory.



### > 3 operating directions



Direct front operation



External right side operation



External front or left side operation

# Socomec worldwide

## IN EUROPE

### BELGIUM

Critical Power / Power Control & Safety /  
Energy Efficiency / Solar Power

Tel. +32 2 340 02 30  
Fax +32 2 346 28 99  
info.be@socomec.com

### FRANCE

Critical Power / Power Control & Safety /  
Energy Efficiency / Solar Power

Tel. +33 1 45 14 63 00  
Fax +33 1 48 67 31 12  
dcm.ups.fr@socomec.com

### GERMANY

Critical Power

Tel. +49 621 71 68 40  
Fax +49 621 71 68 444  
info.ups.de@socomec.com

Power Control & Safety / Energy Efficiency

Tel. +49 7243 65292 0  
Fax +49 7243 65292 13  
info.scp.de@socomec.com

### ITALY

Critical Power

Tel. +39 02 98 242 942  
Fax +39 02 98 240 723  
info.ups.it@socomec.com

Power Control & Safety / Energy Efficiency

Tel. +39 02 98 49 821  
Fax +39 02 98 24 33 10  
info.scp.it@socomec.com

Solar Power

Tel. +39 0444 598611  
Fax +39 0444 598627  
info.solar.it@socomec.com

### NETHERLANDS

Critical Power / Power Control & Safety /  
Energy Efficiency / Solar Power

Tel. +31 30 760 0900  
Fax +31 30 637 2166  
info.nl@socomec.com

### POLAND

Critical Power

Tel. +48 22 825 73 60  
Fax. +48 22 825 73 60  
info.ups.pl@socomec.com

Power Control & Safety / Energy Efficiency

Tel. +48 91 442 64 11  
Fax +48 91 442 64 19  
info.scp.pl@socomec.com

### PORTUGAL

Critical Power / Solar Power

Tel. +351 261 812 599  
Fax +351 261 812 570  
info.ups.pt@socomec.com

### ROMANIA

Critical Power / Power Control & Safety /  
Energy Efficiency / Solar Power

Tel. +40 21 319 36 88  
Fax +40 21 319 36 89  
info.ro@socomec.com

### RUSSIA

Critical Power / Power Control & Safety /  
Energy Efficiency / Solar Power

Tel. +7 495 775 19 85  
Fax +7 495 775 19 85  
info.ru@socomec.com

### SLOVENIA

Critical Power / Power Control & Safety /  
Energy Efficiency / Solar Power

Tel. +386 1 5807 860  
Fax +386 1 561 11 73  
info.si@socomec.com

### SPAIN

Critical Power / Power Control & Safety /  
Energy Efficiency / Solar Power

Tel. +34 93 540 75 75  
Fax +34 93 540 75 76  
info.es@socomec.com

### TURKEY

Critical Power / Power Control & Safety /  
Energy Efficiency / Solar Power

Tel. +90 216 540 71 20-21-22  
Fax +90 216 540 71 27  
info.tr@socomec.com

### UNITED KINGDOM

Critical Power

Tel. +44 1285 863 300  
Fax +44 1285 862 304  
info.ups.uk@socomec.com

Power Control & Safety / Energy Efficiency

Tel. +44 1462 440 033  
Fax +44 1462 431 143  
info.scp.uk@socomec.com

## IN ASIA PACIFIC

### AUSTRALIA

Critical Power / Power Control & Safety

Tel. +61 2 9325 3900  
Fax +61 2 9888 9544  
info.ups.au@socomec.com

### CHINA

Critical Power / Power Control & Safety /  
Energy Efficiency

Tel. +86 21 52 98 95 55  
Fax +86 21 62 28 34 68  
info.cn@socomec.com

### INDIA

Critical Power / Solar Power

Tel. +91 44 39215400  
Fax +91 44 39215450 & 51  
info.ups.in@socomec.com  
info.solar.in@socomec.com

Power Control & Safety / Energy Efficiency

Tel. +91 124 4027210  
Fax +91 124 4562738  
info.scp.in@socomec.com

### SINGAPORE

Critical Power / Power Control & Safety /  
Energy Efficiency

Tel. +65 6506 7600  
Fax +65 64 58 7377  
info.sg@socomec.com

### THAILAND

Critical Power

Tel. +66 2 941 1644 7  
Fax +66 2 941 1650  
info.ups.th@socomec.com

### VIETNAM

Critical Power

Tel. +84 8 3559 1220  
Fax +84 8 3559 1221  
info.ups.vn@socomec.com

## IN MIDDLE EAST

### UNITED ARAB EMIRATES

Critical Power / Power Control & Safety /  
Energy Efficiency / Solar Power

Tel. +971 4 29 98 441  
Fax +971 4 29 98 449  
info.ae@socomec.com

## IN AMERICA

### USA, CANADA & MEXICO

Power Control & Safety / Energy Efficiency

Tel. +1 617 245 0447  
Fax +1 617 245 0437  
info.us@socomec.com

## OTHER COUNTRIES

### NORTH AFRICA

Algeria / Morocco / Tunisia  
info.naf@socomec.com

### AFRICA

Other countries  
info.africa@socomec.com

### SOUTH EUROPE

Cyprus / Greece / Israel / Malta  
info.se@socomec.com

### SOUTH AMERICA

Tel. +34 93 540 75 75  
info.es@socomec.com

### MORE DETAILS

[www.socomec.com/worldwide](http://www.socomec.com/worldwide)

## HEAD OFFICE

### SOCOMECS GROUP

S.A. SOCOMECS capital 10 816 800€  
R.C.S. Strasbourg B 548 500 149  
B.P. 60010 - 1, rue de Westhouse  
F-67235 Benfeld Cedex - FRANCE  
Tel. +33 3 88 57 41 41  
Fax +33 3 88 74 08 00  
info.scp.isd@socomec.com

[www.socomec.com](http://www.socomec.com)

## YOUR DISTRIBUTOR

